

BEGA**31 455**

Wall luminaire



Project · Reference number

Date

Product data sheet

Application

Wall luminaire made of copper with double-sided light exit.
Fully glare free light for lighting wall surfaces.
For interior or exterior lighting design.

Product description

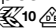
Luminaire made of copper,
brass and stainless steel
Opal glass
Silicone gasket
Reflector made of pure anodised aluminium
2 fixing holes \varnothing 4.5 mm
212 mm spacing
1 cable entry for mains supply cable
up to \varnothing 10,5 mm max. $3 \times 1,5^{\square}$
Connecting terminal 2.5^{\square}
Earth conductor connection
Lampholder E 27
Safety class I
Protection class IP 54
Protection against harmful dust deposits and splash water
 – Safety mark
 – Conformity mark
Weight: 2.1 kg

Copper

The luminaire parts made of solid copper are delivered with the metal's natural surface colour.
Time and weather factors create the natural patina characteristic for copper.

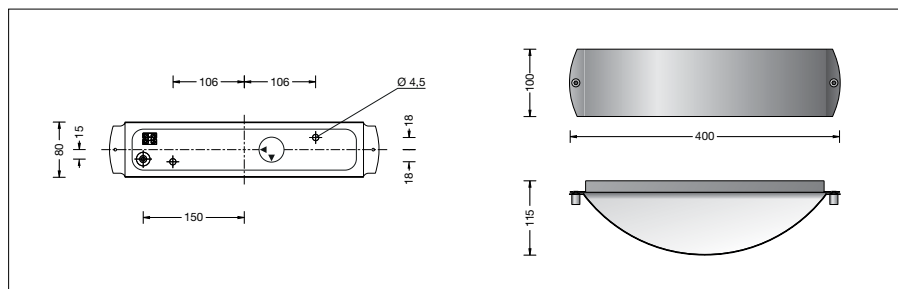

Lamps

Luminaire with lampholder E 27
Lamp wattage max. 2 x 60 W

2 High voltage tungsten halogen lamps · E 27
Osram: Halogen Eco Classic A · 46 W 700 lm
Philips: Eco Classic A-shape · 42 W 630 lm

Please note the lamp manufacturers' operating instructions.