

BEGA**33 019**

Recessed luminaire



Project · Reference number

Date

Product data sheet

Application

Shielded LED luminaire for walls and stairs.

Product description

Luminaire made of aluminium alloy,
aluminium and stainless steel
Matt safety glass
Silicone gasket
Fixing is achieved by using two adjustable
wedge-shaped claws
Required recessed opening 306 x 60 mm
Recessed depth 70 mm
2 cable entries for through-wiring of mains
supply cable \varnothing 7-10,5 mm,
max. 3 G 1.5[□]
Connecting terminal 2.5[□]
Earth conductor connection
LED power supply unit
220-240 V \sim 0/50-60 Hz
DC 176-264 V
Safety class I
Protection class IP 65
Dust-tight and protection against water jets
Impact strength IK08
Protection against mechanical
impacts < 5 joule
 – Safety mark
 – Conformity mark
Weight: 1.0 kg

Inrush current

Inrush current: 7 A / 112 μ s
Maximum number of luminaires of this
type per miniature circuit breaker:
B 10A: 38 luminaires
B 16A: 61 luminaires
C 10A: 64 luminaires
C 16A: 102 luminaires

Lamp

Module connected wattage	3.8 W
Luminaire connected wattage	4.9 W
Rated temperature	$t_a = 25^\circ\text{C}$
Ambient temperature	$t_{a\text{max}} = 45^\circ\text{C}$
When installed in heat-insulating material	$t_{a\text{max}} = 40^\circ\text{C}$

On request we can offer you modifications for
environments with higher temperatures as a
customized product.

33 019 K3

Module designation	LED-0644/830
Colour temperature	3000 K
Colour rendering index	CRI > 80
Module luminous flux	670 lm
Luminaire luminous flux	64 lm
Luminaire luminous efficiency	13,1 lm/W

33 019 K4

Module designation	LED-0644/840
Colour temperature	4000 K
Colour rendering index	CRI > 80
Module luminous flux	705 lm
Luminaire luminous flux	69 lm
Luminaire luminous efficiency	14,1 lm/W

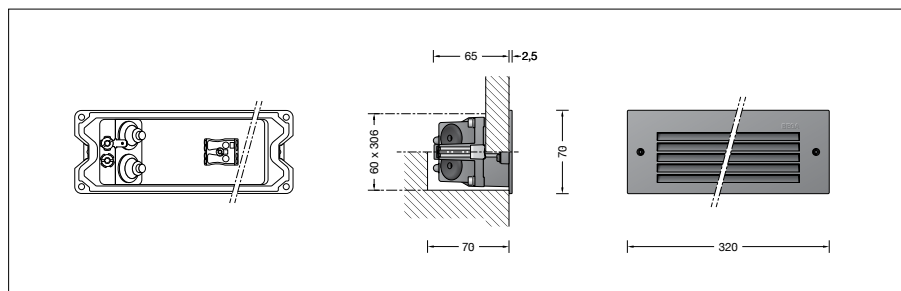

Lifetime of the LED

Ambient temperature $t_a = 15^\circ\text{C}$
– at 50,000 h: L90 B10
– at 220,000 h: L70 B50

Ambient temperature $t_a = 25^\circ\text{C}$
– at 50,000 h: L90 B50
– at 195,000 h: L70 B50

max. ambient temperature $t_a = 45^\circ\text{C}$
– at 50,000 h: L90 B50
– at 180,000 h: L70 B50

Article No. 33 019

LED colour temperature optionally 3000 K
or 4000 K
3000 K – Article number + **K3**
4000 K – Article number + **K4**

Colour graphite or silver
graphite – article number
silver – article number + **A**

Accessories

10 426 Installation housing
13 521 Installation housing for installation in
insulated facades (EWIS)

10 026 Plaster frame
13 505 Plaster frame flush

A separate instructions for use can be provided
upon request.

Light distribution

