

BEGA**33 055**

Recessed luminaire



Project · Reference number

Date

Product data sheet

Application

LED luminaire with asymmetrical light distribution for installation in walls or stairs.

Product description

Luminaire made of aluminium alloy, aluminium and stainless steel
 Clear safety glass
 Silicone gasket
 Fixing is achieved by using two adjustable wedge-shaped claws
 Required recessed opening 306 x 60 mm
 Recessed depth 70 mm
 2 cable entries for through-wiring of mains supply cable \varnothing 7-10,5 mm, max. 3G 1.5[□]
 Connecting terminal 2.5[□]
 Earth conductor connection
 LED power supply unit
 220-240 V \sim 0/50-60 Hz
 DC 170-280 V
 Safety class I
 Protection class IP 65
 Dust-tight and protection against water jets
 Impact strength IK08
 Protection against mechanical impacts < 5 joule
 – Safety mark
CE – Conformity mark
 Weight: 0.95 kg

Inrush current

Inrush current: 27 A / 250 μ s
 Maximum number of luminaires of this type per miniature circuit breaker:
 B 10 A: 17 luminaires
 B 16 A: 27 luminaires
 C 10 A: 28 luminaires
 C 16 A: 46 luminaires

Lamp

Module connected wattage	8.2 W
Luminaire connected wattage	11 W
Rated temperature	$t_a = 25^\circ\text{C}$
Ambient temperature	$t_{a\text{max}} = 25^\circ\text{C}$

On request we can offer you modifications for environments with higher temperatures as a customized product.

33 055 K3

Module designation	LED-0543/830
Colour temperature	3000 K
Colour rendering index	CRI > 80
Module luminous flux	1130 lm
Luminaire luminous flux	480 lm
Luminaire luminous efficiency	43,6 lm/W

33 055 K4

Module designation	LED-0543/840
Colour temperature	4000 K
Colour rendering index	CRI > 80
Module luminous flux	1130 lm
Luminaire luminous flux	480 lm
Luminaire luminous efficiency	43,6 lm/W

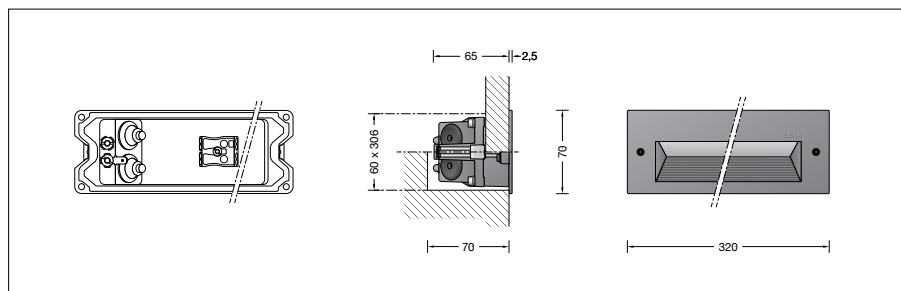

Lifetime of the LED

Ambient temperature $t_a = 15^\circ\text{C}$
 – at 50,000 h: L 90 B 10
 – at 374,000 h: L 70 B 50

max. ambient temperature $t_a = 25^\circ\text{C}$
 – at 50,000 h: L 80 B 10
 – at 202,000 h: L 70 B 50

Article No. 33 055

LED colour temperature optionally 3000 K or 4000 K
 3000 K – Article number + **K3**
 4000 K – Article number + **K4**

Colour graphite or silver
 graphite – article number
 silver – article number + **A**

Accessories

10 426 Installation housing
13 521 Installation housing for installation in insulated facades (EWIS)

10 026 Plaster frame
13 505 Plaster frame flush

A separate instructions for use can be provided upon request.

Light distribution

