

## Ultra 12 Spot Light Dim to Warm



|          |
|----------|
| PROJECT: |
| TYPE:    |
| SOURCE:  |
| NOTES:   |

### SPECIFICATIONS

IK10 IP67 CE (PENDING) cUL US LISTED

|                           |   |
|---------------------------|---|
| LED Chip                  | Bridgelux field replaceable LED board   |
| Luminaire Output          | 1000 Lumens minimum 1800-3000K@ 350mA (12 watts), delivered from the Luminaire with unobstructed beam |
| Lumens Per Watt           | 83 Lumens minimum @ 12 watts, delivered from Luminaire with unobstructed beam                         |
| CRI (3000K)               | 90 Standard   |
| Colour Temperatures       | 2700K - 5000K tunable white   |
| Beam Angles               | 18, 24, 46, 60  |
| Ingress Protection        | IP67  |
| Inverse Kinematics Rating | IK10  |
| Warranty                  | Electronics = 5 years<br>Aluminium Body = 5 years   |
| Standards                 | BS/EN 60598.2.2<br>cUL 1598, 2108, 1838 (PENDING)<br>CE   |

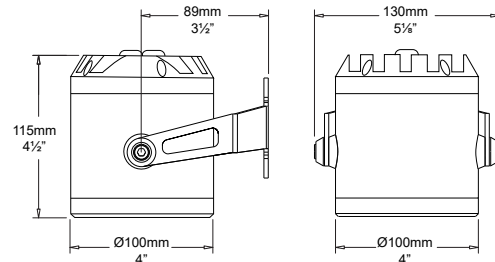

\*The Ultra 12 Spot must be specified with a mounting accessory.

### PRODUCT CONFIGURATION

Please fill in appropriate codes into boxes provided

Cat. No. SDW/U12

| Luminaire   | Power | Material/Finish   | Beam   | Colour         | Accessories  |
|---|-------|-------------------|--------|----------------|--|
| SDW/U12   |       |                   |        |                |  |
| SR Series Remote  |       |                   |        |                |  |
| SR<br>Series Remote Driver<br>Constant current driver (included)<br>individual fixtures require 36vf @ 350mA maximum. |       | ALUMINIUM         |        | DW Dim to Warm |  |
|   |       | EBK BLACK         | 18 18° |                | CJK Cable Joint Kit  |
|   |       | EBZ BRONZE        | 24 24° |                | HCL/U12 Hex Cell Louvre  |
|   |       | EOGR OLIVE GREEN  | 46 46° |                | ULT12GG Glare Guard  |
|   |       | EWH WHITE         | 60 60° |                | ULT12SNT Snoot   |
|   |       | EWB WHITE BIRCH   |        |                | <b>Mounting Options</b><br>*Luminaire must be specified with a mounting accessory. |
|   |       | EDG DARK GREY     |        |                | PB/U12 Pole Bracket*   |
|   |       | ESTAR SILVER STAR |        |                | ULT12SPK Spike*  |
|   |       | ECT CORTEN        |        |                | ULT12WP Wall Plate*  |

Additional Comments:

\*Due to continued product enhancements, specifications may change without notification.

# LUMINAIRE CONSTRUCTION

**CNC machined from one of the following metals:**

**Aluminium:**

Body: 101mm (4") high corrosion resistant aluminium rod with chromate substrate and high UV resistant polyester powder coat.

Colours: Black, Bronze, Silver Star, White, White Birch, Olive Green, Dark Grey, Corten.

**316 Stainless Steel:**

Bracket: laser cut and folded 316 stainless steel.

**Adjustability:**

The fully adjustable head allows 120 degree rotation and 0-120 degree elevation.

**Cable:**

Water resistant rubber.

**Gaskets:**

Silicone, iron impregnated 220°C (428°F).

**Step Lens:**

12mm (1/2") extra clear, low iron, shatter resistant glass. Lifetime warranty.

**Mounting:**

The mounting bracket is fixed to the surface using two stainless steel screws.

Pole Bracket - mount to pre-installed poles.

Spike - mount into the earth/soft ground.

Wall Plate - mount over junction boxes.

**Luminaire Weight:**

2kg (4lb 6.5oz)

## ACCESSORIES

\*Luminaire must be specified with a mounting accessory.

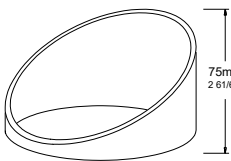

Glare Guard

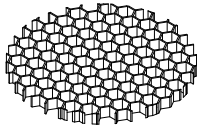

Hex Cell Louvre

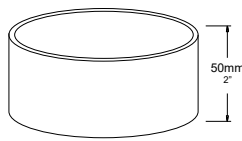

Snoot

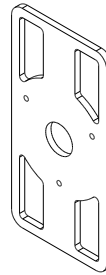

Pole Bracket\*

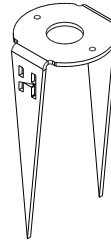

Spike\*

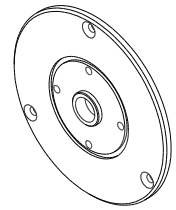

Wall Plate\*  
127mm (5")

## BEAM ANGLES

High efficiency Reflectors. Field replaceable

IES files available for download: [hunzalighting.com/downloads](http://hunzalighting.com/downloads)

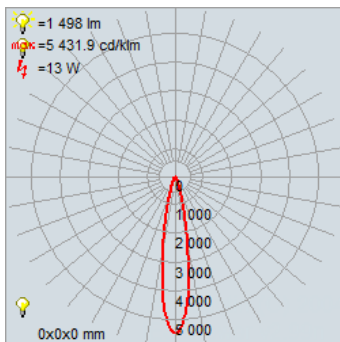

18° FWHM  
TIR

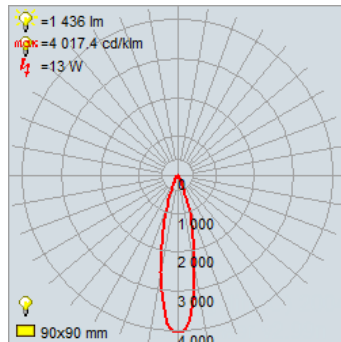

24° FWHM  
TIR

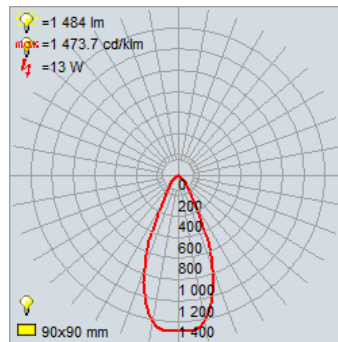

46° FWHM  
TIR

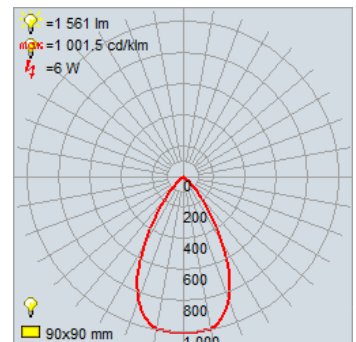

60° FWHM  
TIR

## WIRING GUIDE

Available for download: [hunzalighting.com/downloads](http://hunzalighting.com/downloads)

**NOTE:** Diagrams are a guide only, wire colours and polarity may change depending on fixture and country.

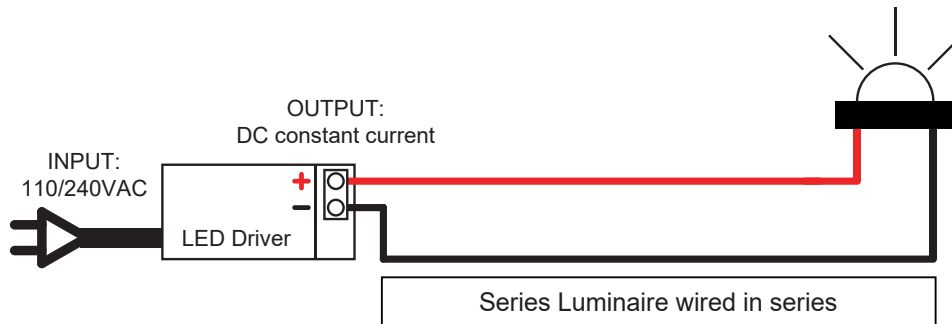

\*Due to continued product enhancements, specifications may change without notification.



**HUNZA LIGHTING**  
130 Felton Mathew Ave  
Saint Johns  
Auckland 1072  
New Zealand

Ph: +64-9-528 9471  
Fax: +64-9-528 9471  
hunza@hunza.co.nz  
www.hunzalighting.com

**INTERNATIONAL CONTACTS:**  
[www.hunzalighting.com/contact](http://www.hunzalighting.com/contact)

This document contains proprietary information of Hunza™. Its receipt or possession does not convey any rights to reproduce or disclose its content.